

# MSVU RESIDENCE STUDENT WEBINAR

Todd MacDonald, MSVU Residence Life Manager

[Todd.macdonald10@msvu.ca](mailto:Todd.macdonald10@msvu.ca)

[residence@msvu.ca](mailto:residence@msvu.ca)

902-457-5520



# Overview of Webinar

1. MSVU Residence Goals
2. Overview of Residence Life
3. Before Your Student Arrives
4. Move In Day
5. Living in Residence
6. Resources and Communication
7. Advice and Questions

# MSVU Residence Goals

- The goal for MSVU Residence Life is to help you transition into living away from home and grow.
- We want students to learn how to live communally and grow personally as well as academically
- MSVU Residence Life provides a safe place where students can learn, make mistakes and try new things
- We want to ensure that all students have a comfortable space where they can study and socialize



# Overview of Residence Life

There are three residence options at MSVU which caters to almost 400 students each year.

**Assisi Hall** - Ideal for first-year students, the 12-story building overlooks the Bedford Basin and houses 130 students, all in single rooms. Assisi Hall offers laundry facilities for convenience as well as lounge areas with kitchenettes for socializing. Assisi is connected to the Rosaria Student Centre which connects it to other buildings on campus.

**The Birches** – This group of five spacious townhouses is a nice mix for everyone. The birches each have 21 single rooms complete with a lounge, a kitchenette (full kitchen in Birch 5), and a laundry room. \*Birch 5 is 19+

**Westwood** - The Mount's apartment style residence geared for senior or transfer students (19 and older), Westwood has mostly four-bedroom fully furnished apartments complete with living room, kitchen, and two bathrooms. If apartment living isn't for you, Westwood also offers a floor of single dorm-style rooms. This floor also boasts lounges and a kitchenette.



# Assisi Hall

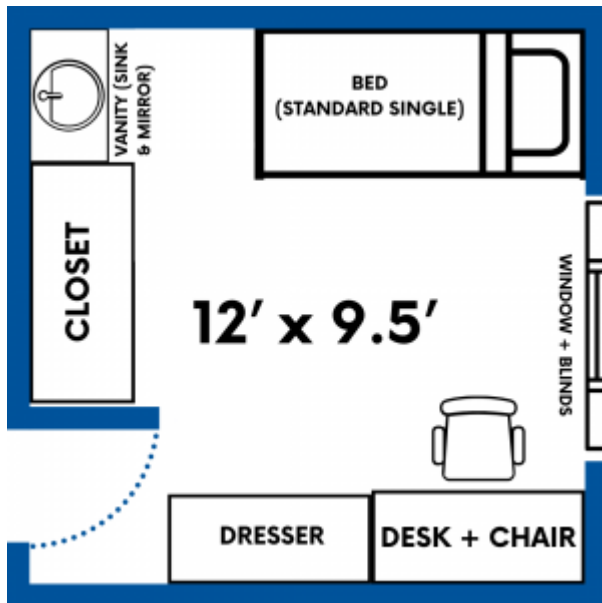

## Single rooms in Assisi Hall have:

- Closet with storage space
- Windows with blinds
- Desk with built-in shelves and a light
- Desk chair
- Waste and recycling basket
- Dresser with three drawers
- Single captain's bed
- Sink and vanity
- Indoor access to all the campus
- **Room Size: 12' x 9.5'**

# The Birches

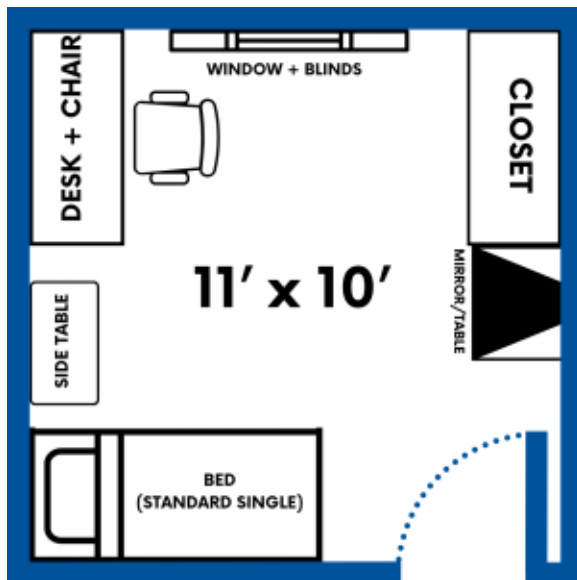

## All rooms in The Birches contain:

- Closet with storage space
- Windows with blinds
- Desk with built-in shelves and a light
- Desk chair
- Waste and recycling basket
- Dresser with three drawers
- Single Captains' bed
- **Room Size: 11' x 10'**
- **\*Birch 5 Comes with Full Kitchen Access**

# Westwood Single

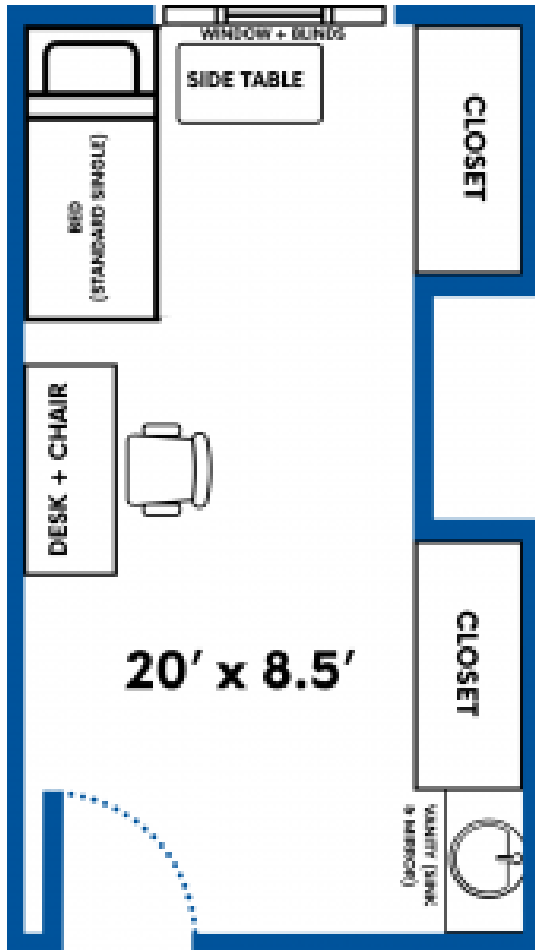

## All Westwood Single Rooms Contain:

- Single captain's bed
- Sink
- Storage closet with shelving and drawers
- Desk with built-in shelves and a light
- High-speed internet
- Local phone
- Room Size: 20' x 8.5'**

# Westwood Apartment

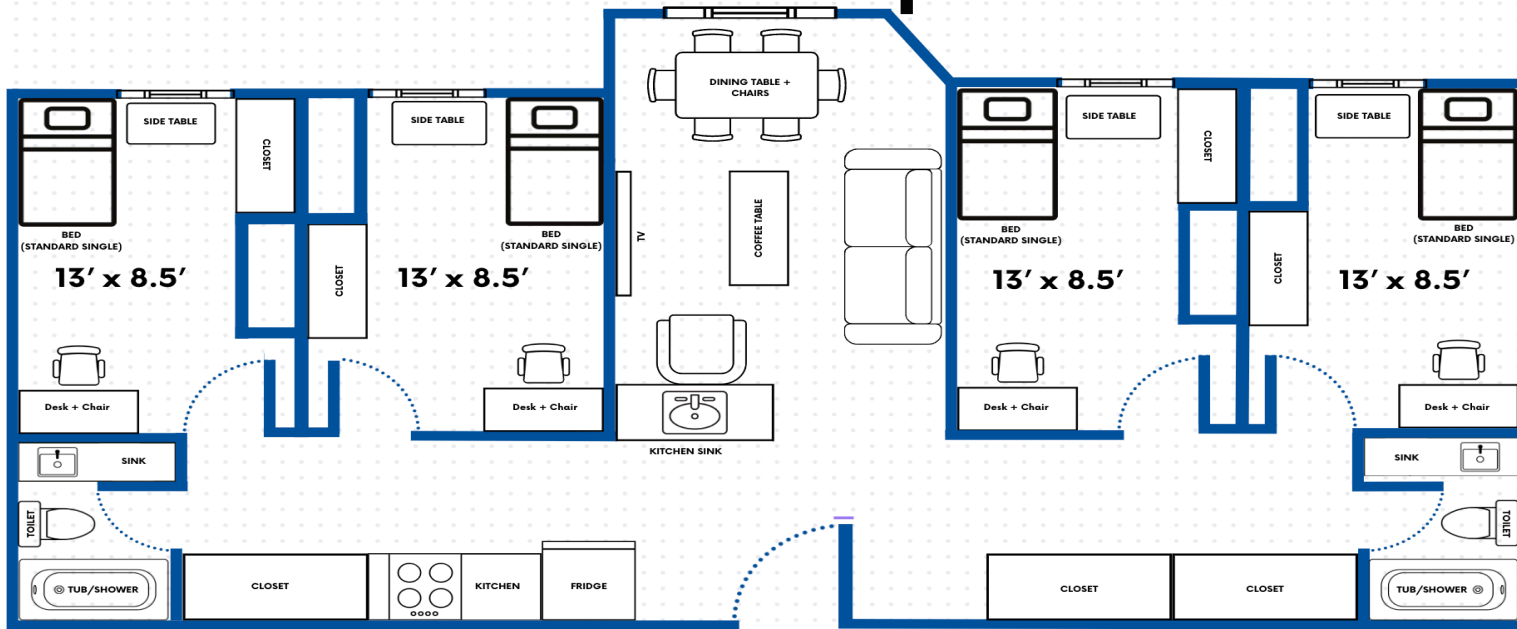

## All Westwood Apartments Contain:

- Full kitchen (stove, oven, fridge with freezer, microwave, toaster, and kettle)
- Two full bathrooms
- Four single rooms (including captain's bed, desk, and chair, bookshelf,
- Wardrobe with shelves and night side table), Furnished living room
- High-speed internet
- A phone
- Flat Screen TV
- **Bedroom Size: 13' x 8.5'**



# Summer and Holiday Residence

- In the Summer sessions (after the Winter semester has ended) only Birch 4 and Birch 5 are available.
- Much of the other residence rooms are taken over by conference services and rented as a hotel.
- Support is offered from the Residence Life Office but there is less in building support from RAs and Dons.
- Residence also closes for the holidays on December 16<sup>th</sup>. You can choose to stay in Residence over the holidays for a small fee. The Rosaria dining hall will be closed at this time (however, cooking equipment will be provided).



# Frequently Asked Information

- While all furniture (bed, desk, lighting) is provided, you will have to bring your own sheets, blankets and pillows.
- Some bathroom supplies are supplied. Bathrooms are cleaned by custodians Monday-Friday (except those in apartments) and toilet paper is provided. You will need to bring any soap, shampoo, or conditioner you use in the shower. Hand soap is provided.
- Washers and dryers are provided and are included in your fees. There is no additional cost for them. You will have to provide your own laundry detergent.
- The only thing that can go into the toilet is toilet paper. Please do not buy wipes (even those that say flushable). They will damage the plumbing.
- In all spaces except apartment style, garbage bags and room cleaning supplies are provided. Please ensure you follow all local recycling rules.



# Meal Plans

Every student living in Residence is required to purchase a meal plan. This is added to your student account. A brief description of meal plans are below:

MEAL PLANS	DETAILS	Price Per Term	Price Per Year	FLEX Dollars Per Term
POD 7	7 day all you care to eat Rosaria Dining Hall	\$2,732.50	\$5,465.00	\$145.00
POD 5	5 day all you care to eat Rosaria Dining Hall	\$2,580.00	\$5,160.00	\$145.00
FLEX	FLEX only Declining balance	\$615.50	\$1,231.00	\$615.50
FLEX 80	80 meals in Dining Hall with \$200 FLEX	\$779.00	\$1,558.00	\$100.00
FLEX 80 PLUS	90 meals in Dining Hall with \$600 FLEX	\$1,038.50	\$2,077.00	\$300.00
FLEX 200	200 meals in Dining Hall with \$200 FLEX	\$1,542.50	\$3,085.00	\$100.00

 Including, \$25 Housing Dues per term

\*Flex dollars can be used at Rosaria Dining Hall, McCain Café and Seton Café 



# Before You Arrive...

1. Try new things in preparation to moving on campus! Especially when it comes to having more freedom (e.g.: Grocery shopping, using public transit).
2. Some great things to learn: how to do laundry, what can/cannot go into microwaves, how to keep your spaces clean.
3. If you struggle with anxiety, how should you work on strategies that you can bring into Residence? We have resources available.
4. Have you connected with campus services? (financial services, accessibility services, etc.)
5. What are your expectations? Have you thought about or worked on them? Having expectations is great, but don't forget to equip yourself with tools that can meet them.



# Move In Day

1. August 31<sup>st</sup>, 2025
2. Can be a bit of a hectic day, we will be sending emails regarding where to get keys for move in. A full map of where to go will also be provided.
3. Think about how to work with your nerves! Move in day is overwhelming, but you are not alone!
4. Don't miss out on the nighttime event – it is the best time to make new friends
5. If you notice you are still very nervous during move in day, find a Residence Staff member and let them know! We can help you talk it out and make new friends!
6. If you require early move in (for International Days of Orientation or another reason) please fill out this form: <https://forms.office.com/r/OZAj5vucmY>. We do our best to accommodate requests but early move in dates are not confirmed until you hear back from us. For any questions, reach out to [residence@msvu.ca](mailto:residence@msvu.ca).



# Residence Staff

In addition to the office staff, there are 20 Residence Life Team members to help you during your stay.

## Resident Assistant (RA)

- Each residence community block is represented by a Resident Assistant (RA).
- Your RA is your source of information and support. RA's are extensively trained to ensure a smooth residence experience.
- An RA is on duty in your community from 7:00 p.m. to 7:00 a.m. weeknights and weekends.
- Are there for basic supports, they do not replace a counselor or other professional support.

## Residence Don

- Each residence community at the Mount is supported by a DON who in turn supervises the area RAs.
- The DONs are experienced Residence Life Staff who are available in case of emergencies or serious issues.
- All DONs are available to support any students who are in need.
- These are still students who are here for help. They are not professional staff members.



# Living In Residence – General Rules

1. Quiet hours begin at 11pm (more when it is exam time) – help them to think about others.
2. Any smoking needs to be done away from buildings and cannot be done inside. There are designated areas.
3. Fire equipment cannot be tampered with.
4. Visitor Policy needs to be followed – only one overnight guest; they cannot come every night
5. Microwaves and full size fridges are not allowed
6. The expectation is that they would keep their room clean and clean up after themselves in common spaces.

# Resources and Communication

1. Residence Life Staff (students) cannot talk to parents. If your guardian/parent have a concern, they can call security or the Residence Life Office
  1. Please note: we cannot share information about students.
2. You will receive a list of student resources when you move in, but if you have questions or ever need better guidance, your RA is your best resource to make sure you can access the best support available at that time.
3. Students can always come to the Residence Life Office if they have a question.





# End of Year

Residence closes for the winter semester in **April 2026**. If you wish/need to stay after this date, there is a fee, and you may be asked to move to another room. Space is limited and will be given on a first come-first serve basis. An application for summer residence will be sent out in late January/Early February.



**Thank you for listening and we are excited to welcome your student(s) into residence this year. I am happy to answer any questions you may have.**

