

# WELCOME TO RESIDENCE AT MSVU

Todd MacDonald, Residence Life Manager at MSVU

[todd.macdonald10@msvu.ca](mailto:todd.macdonald10@msvu.ca)

[residence@msvu.ca](mailto:residence@msvu.ca)

902-457-5520



# Overview of Webinar

1. Residence Options
2. What to bring and not bring
3. Residence Rules
4. What is an RA/Don?
5. Early Move In/Holiday Stay

# Residence Options

There are three residence options at MSVU which caters to almost 400 students each year.

**Assisi Hall** - Ideal for first-year students, the 12-story building overlooks the Bedford Basin and houses 130 students, all in single rooms. Assisi Hall offers laundry facilities for convenience as well as lounge areas with kitchenettes for socializing. Assisi is connected to the Rosaria Student Centre which connects it to other buildings on campus.

**The Birches** – This group of five spacious townhouses is a nice mix for everyone. The birches each have 21 single rooms complete with a lounge, a kitchenette (full kitchen in Birch 5), and a laundry room. \*Birch 5 is 19+

**Westwood** - The Mount's apartment style residence geared for senior or transfer students (19 and older), Westwood has mostly four-bedroom fully furnished apartments complete with living room, kitchen, and two bathrooms. If apartment living isn't for you, Westwood also offers a floor of single dorm-style rooms. This floor also boasts lounges and a kitchenette.



# Assisi Hall

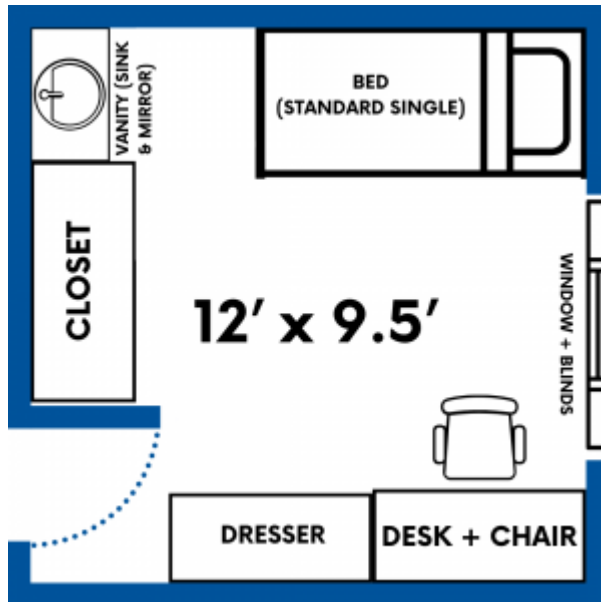

## Single rooms in Assisi Hall have:

- Closet with storage space
- Windows with blinds
- Desk with built-in shelves and a light
- Desk chair
- Waste and recycling basket
- Dresser with three drawers
- Single captain's bed
- Sink and vanity
- Indoor access to all the campus
- **Room Size: 12' x 9.5'**

# The Birches

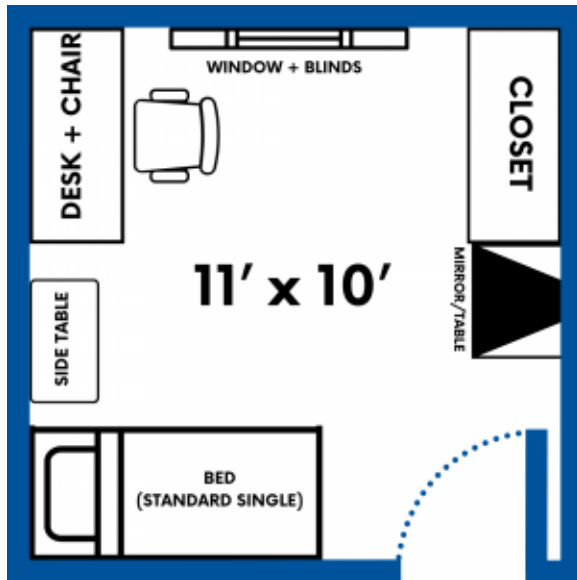

## All rooms in The Birches contain:

- Closet with storage space
- Windows with blinds
- Desk with built-in shelves and a light
- Desk chair
- Waste and recycling basket
- Dresser with three drawers
- Single Captains' bed
- **Room Size: 11' x 10'**
- **\*Birch 5 Comes with Full Kitchen Access**

# Westwood Single

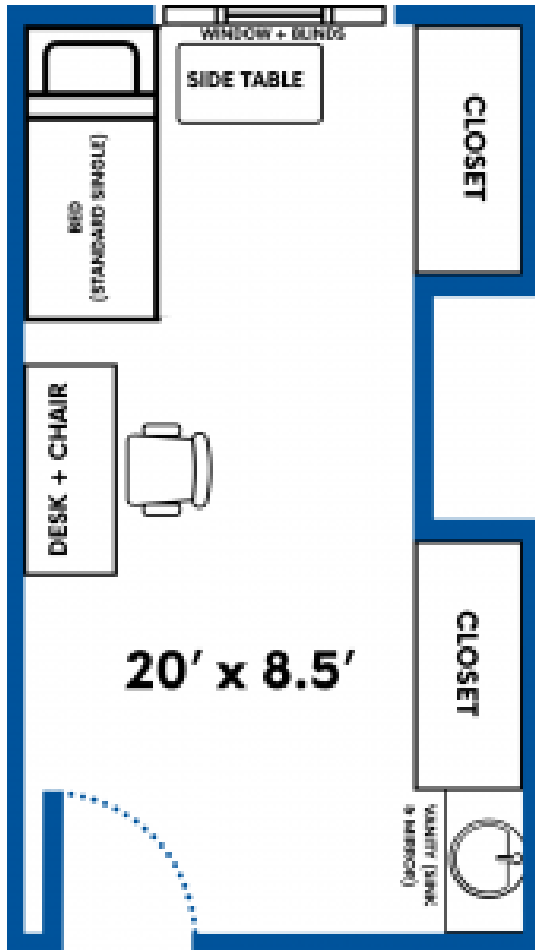

## All Westwood Single Rooms Contain:

- Single captain's bed
- Sink
- Storage closet with shelving and drawers
- Desk with built-in shelves and a light
- High-speed internet
- Local phone
- **Room Size: 20' x 8.5'**

# Westwood Apartment

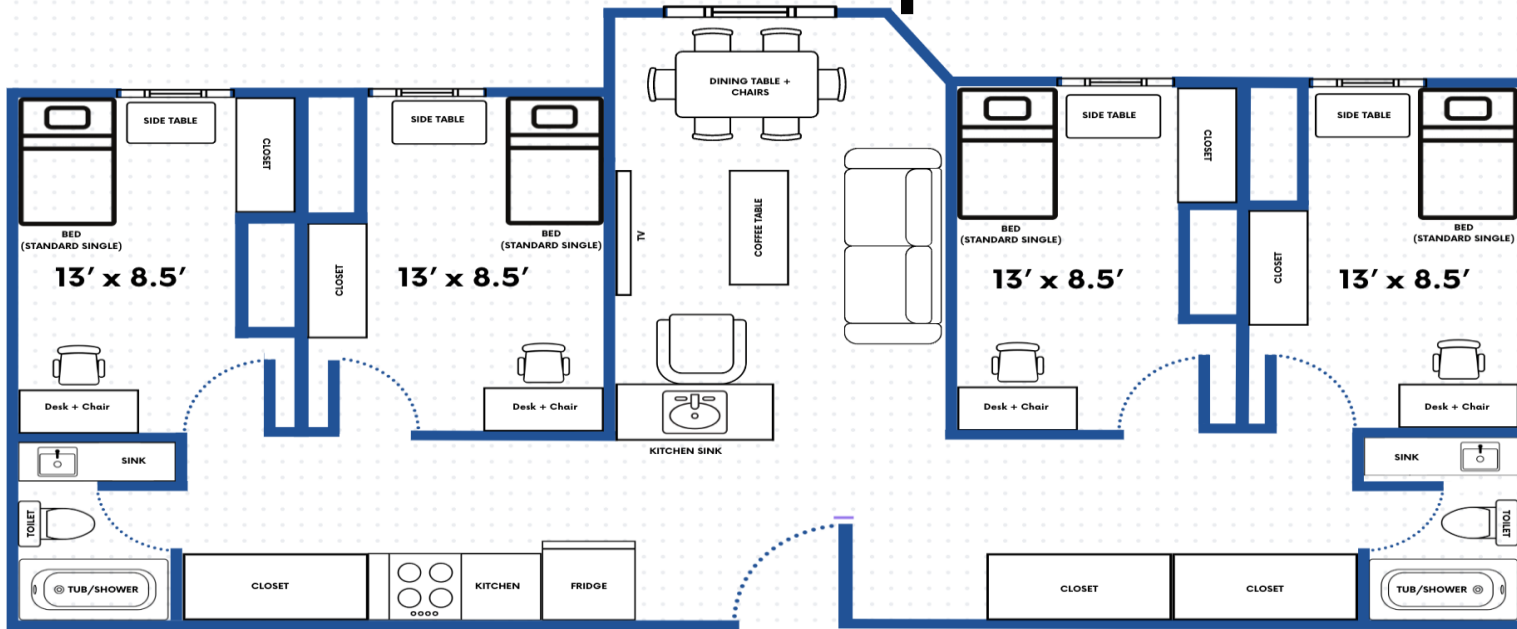

## All Westwood Apartments Contain:

- Full kitchen (stove, oven, fridge with freezer, microwave, toaster, and kettle)
- Two full bathrooms
- Four single rooms (including captain's bed, desk, and chair, bookshelf, Wardrobe with shelves and night side table), Furnished living room
- High-speed internet
- A phone
- Flat Screen TV
- **Bedroom Size: 13' x 8.5'**

# Care and Community Code

- The Caring Community program includes a Residence Life model that engages students fostering an interactive and supportive network of students living on campus.
  - It is your responsibility to familiarize yourself with the rules of residence. We will highlight some here:
1. All residence areas will be open on January 4<sup>th</sup>, 2025. If you would like to register to come early, please use this form: [Early Move In Form](#)
  2. MUST go outside and must be more than 30 feet from all windows. There is no smoking in ANY residence or common areas.
  3. Please be advised that no gatherings of any kind will be permitted outside or around any residences after 11:00 pm.
  4. Candles and any open flames, such as incense burners, tart burners, sparklers, etc., are NOT permitted in residence. There is an automatic fine of \$250.
  5. The only pets allowed in residence are fish in fishbowls no larger than 2 gallons. No fish tanks are permitted.





# Meal Plans

Every student living in Residence is required to purchase a meal plan. This is added to your student account. A brief description of meal plans are below:

## Meal Plan Options

MEAL PLANS	DETAILS	Price Per Term	Price Per Year	FLEX Dollars Per Term
POD 7	7 day all you care to eat Rosaria Dining Hall	\$2,607.50	\$5,215.00	\$145.00
POD 5	5 day all you care to eat Rosaria Dining Hall	\$2,525.00	\$5,050.00	\$145.00
FLEX	FLEX only Declining balance	\$587.50	\$1,175.00	\$587.50
FLEX 80	80 meals in Dining Hall with \$200 FLEX	\$745.00	\$1,490.00	\$100.00
FLEX 80 PLUS	90 meals in Dining Hall with \$600 FLEX	\$991.00	\$1,982.00	\$300.00
FLEX 200	200 meals in Dining Hall with \$200 FLEX	\$1,472.50	\$2,945.00	\$100.00

**In addition, \$25 Housing Dues per term**

**\*Flex dollars can be used at Rosaria Dining Hall, McCain Café and Seton Café**



# Payments

Residence payments are due on January 13<sup>th</sup>, 2025. This is the same date that payments for tuition are due. Payments must be made in full. If you require any extensions or have questions about payments, please reach out to financial services. Their email is [financial.services@msvu.ca](mailto:financial.services@msvu.ca).

<b>Residence Fees 2024 - 2025</b>		<b>ROOM FEES</b>			
<b>Building/Room Type</b>	<b>Residence Per Term</b>	<b>Meal Plan Per Term</b>	<b>Total Per Term</b>	<b>Total Per Academic Year</b>	<b>Mandatory Meal Plan</b>
Assisi	\$3,177.50	\$2,607.50	\$5,785.00	\$11,570.00	POD
Assisi Super Single	\$3,630.00	\$2,607.50	\$6,237.50	\$12,475.00	POD
Birch 1-4	\$3,177.50	\$2,607.50	\$5,785.00	\$11,570.00	POD
Birch 5	\$3,310.00	\$587.50	\$3,897.50	\$7,795.00	ANY
Westwood Apartment Style	\$3,807.50	\$587.50	\$4,395.00	\$8,790.00	ANY
Westwood Single	\$3,630.00	\$2,607.50	\$6,237.50	\$12,475.00	POD

# Residence Staff

In addition to the office staff, there are 20 Residence Life Team members to help you during your stay.

## Resident Assistant (RA)

- Each residence community block is represented by a Resident Assistant (RA).
- Your RA is your source of information and support. RA's are extensively trained to ensure a smooth residence experience.
- An RA is on duty in your community from 7:00 p.m. to 7:00 a.m. weeknights and weekends.

## Residence Don

- Each residence community at the Mount is supported by a DON who in turn supervises the area RAs.
- The DONs are experienced Residence Life Staff who are available in case of emergencies or serious issues.
- All DONs are available to support any students who are in need.



# Move-In

The official move-in day to MSVU Residence is January 4<sup>th</sup>, 2024. Early move-in is available **by application only!** To be eligible for early-move in, you must fill out the Early-Move in Form. The link can be found [here](#).

## Move-In Day

- When you arrive on campus, you will be able to collect your keys from the Assisi front desk. The desk is located on the first floor. Please ensure your lease agreement is signed before you try to get your keys. If you have trouble signing this, please reach out to [residence@msvu.ca](mailto:residence@msvu.ca)

## Early-Move In

- Once your early-move in has been approved, you can arrive on campus on the approved day.
- If you arrive before 5pm on a weekday (Monday-Friday), keys will be with the Residence Life Office.
- If you arrive after 5pm or on a weekend, keys will be at the Assisi Desk.
- Please let [residence@msvu.ca](mailto:residence@msvu.ca) know what time you expect to arrive on campus and we can give you more detailed instructions.



# End of Year

Residence closes for the winter semester on **April 18<sup>th</sup>, 2025 at 12 pm**. If you wish/need to stay after this date, there is a fee, and you may be asked to move to another room. Space is limited and will be given on a first come-first serve basis. An application for summer residence will be sent out in late January/Early February.



**Thank you for listening and we are excited to welcome you into residence this year. I am happy to answer any questions you may have.**

